

## FIGURES

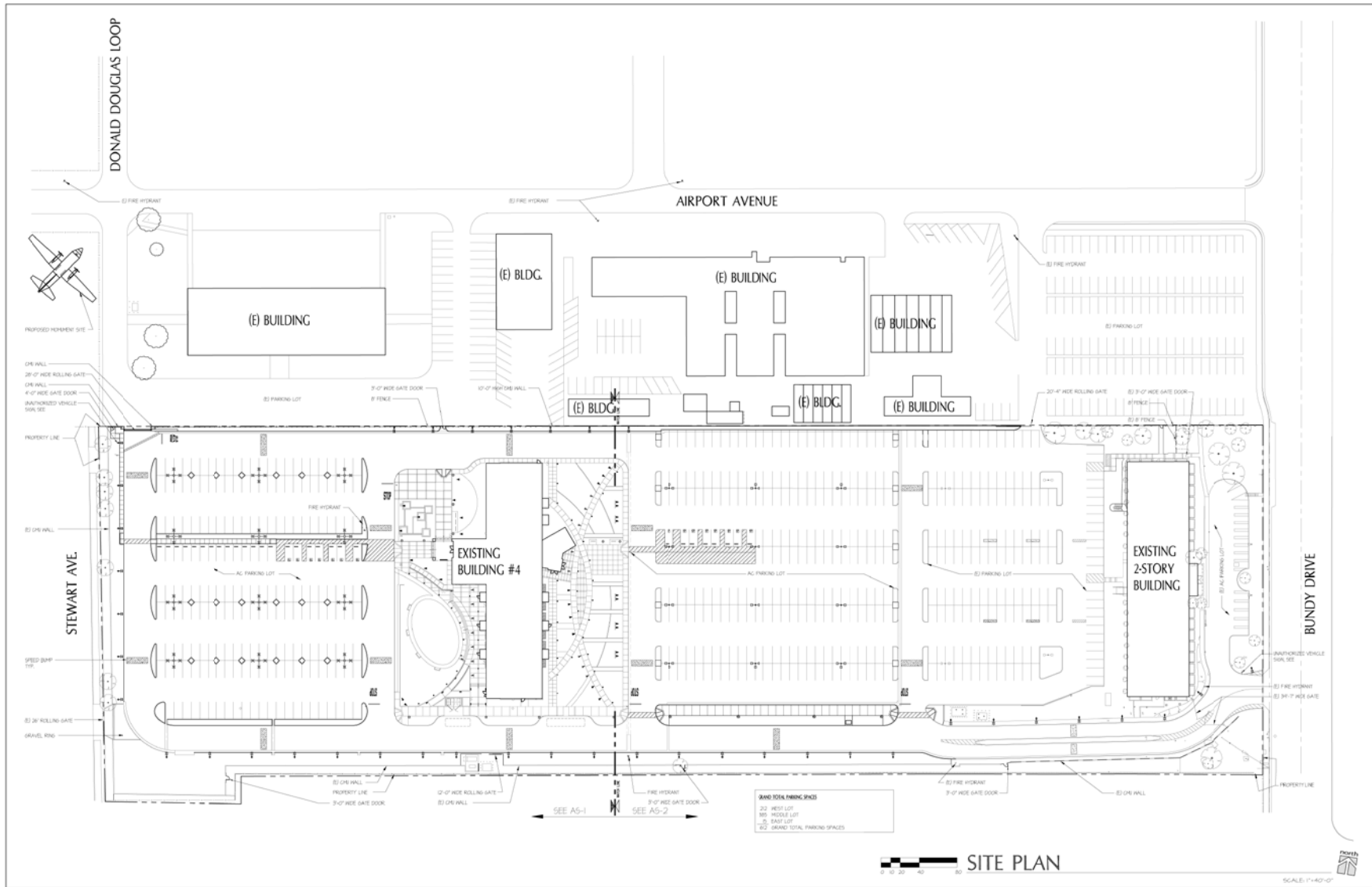

**KAKU** ASSOCIATES

**FIGURE 1**  
**PROPOSED SITE PLAN**

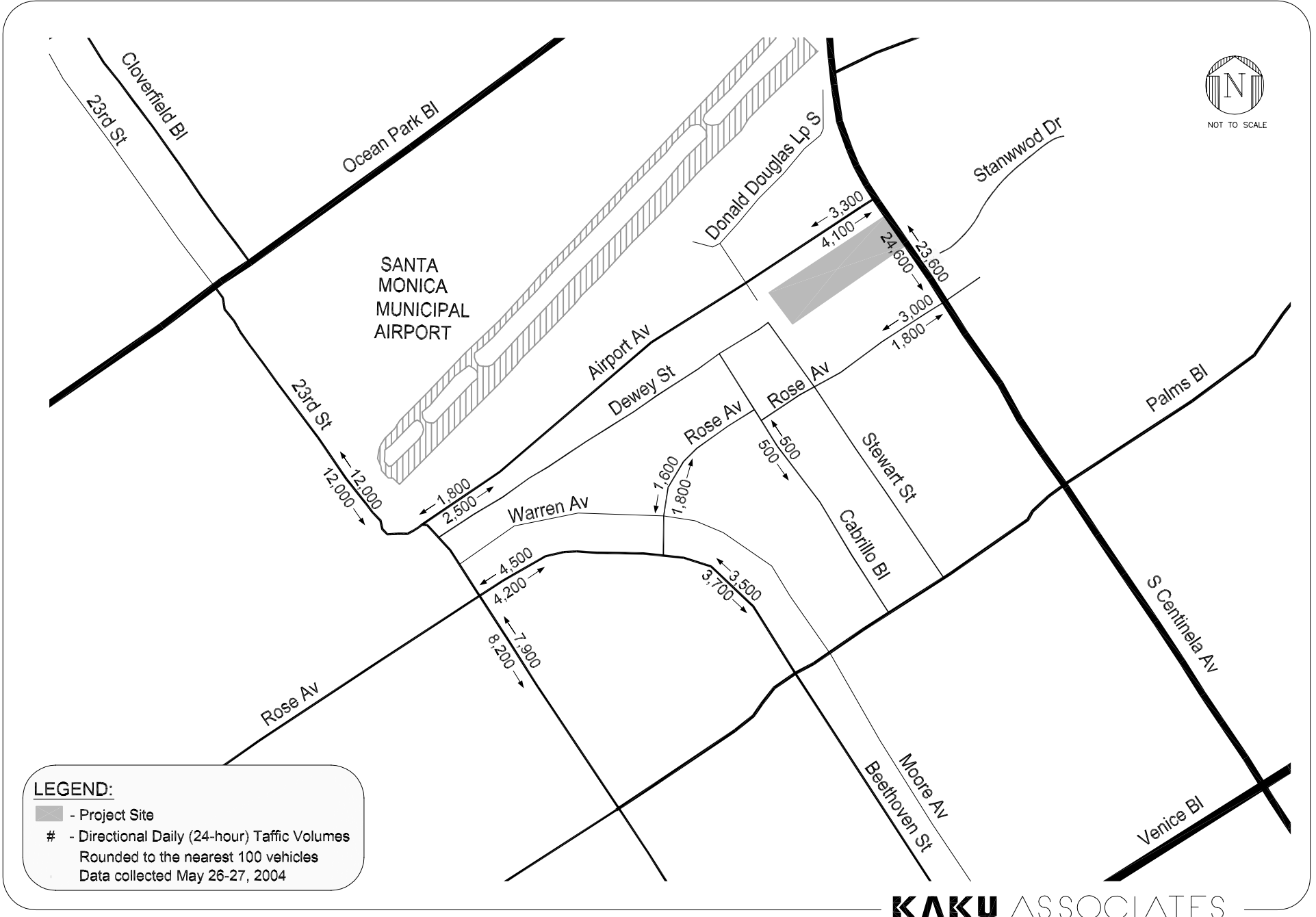

**KAKU ASSOCIATES**

**FIGURE 2  
EXISTING DAILY VOLUMES**



NOT TO SCALE

SANTA  
MONICA  
MUNICIPAL  
AIRPORT

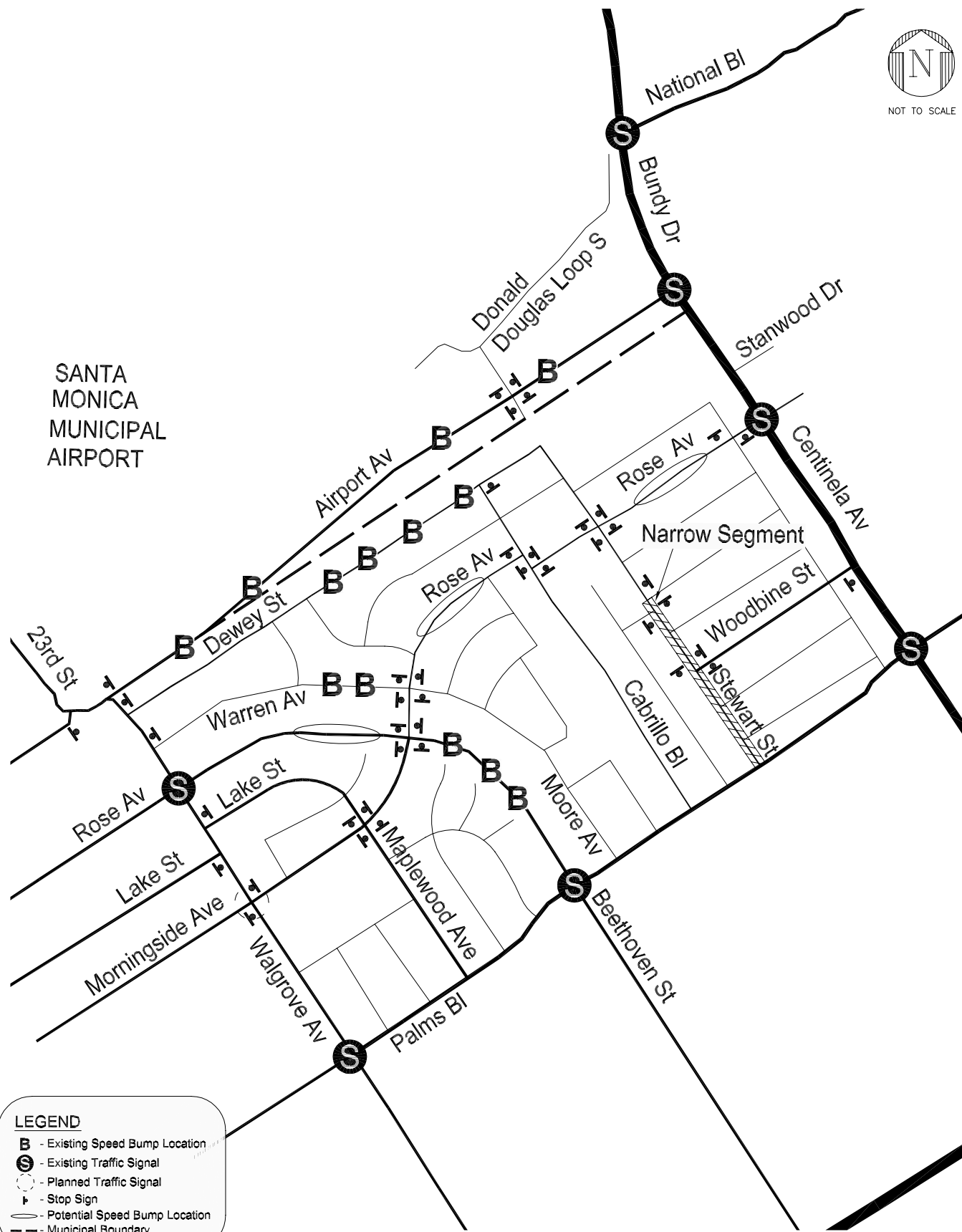

**LEGEND**

- B** - Existing Speed Bump Location
- S** - Existing Traffic Signal
- - Planned Traffic Signal
- T - Stop Sign
- - - Potential Speed Bump Location
- - - Municipal Boundary

**KAKU ASSOCIATES**

**FIGURE 3**  
**EXISTING AND POTENTIAL NEIGHBORHOOD TRAFFIC CONTROLS**

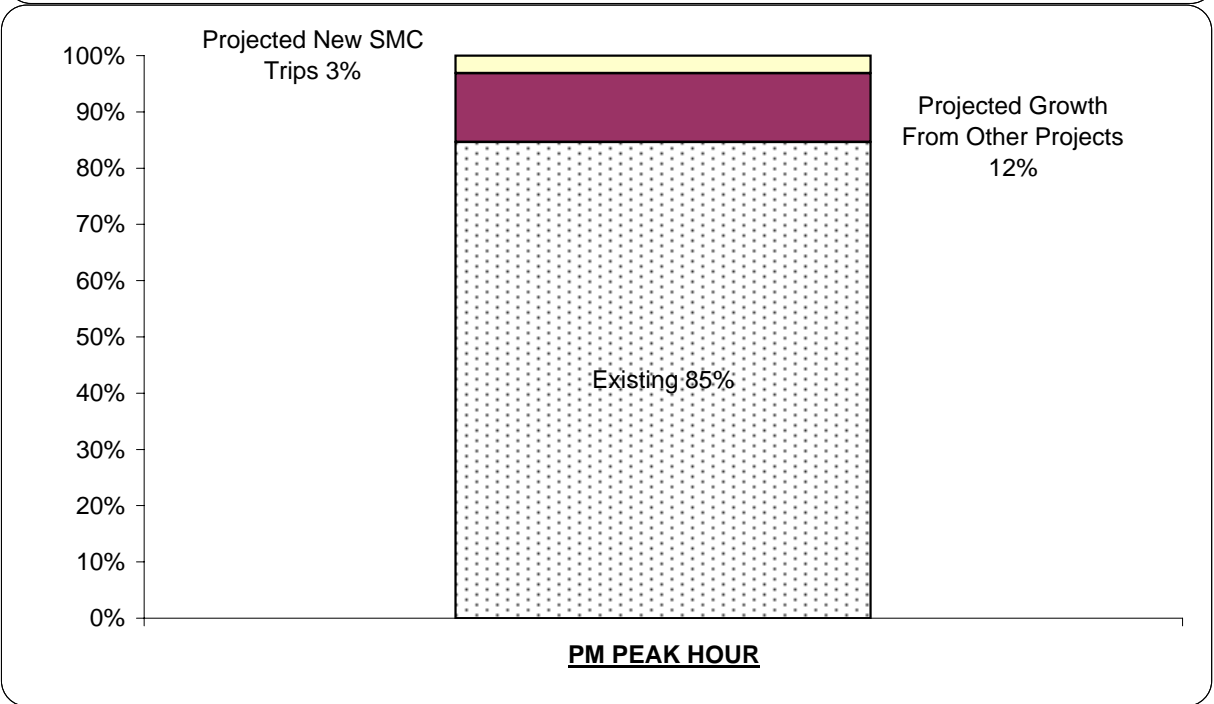
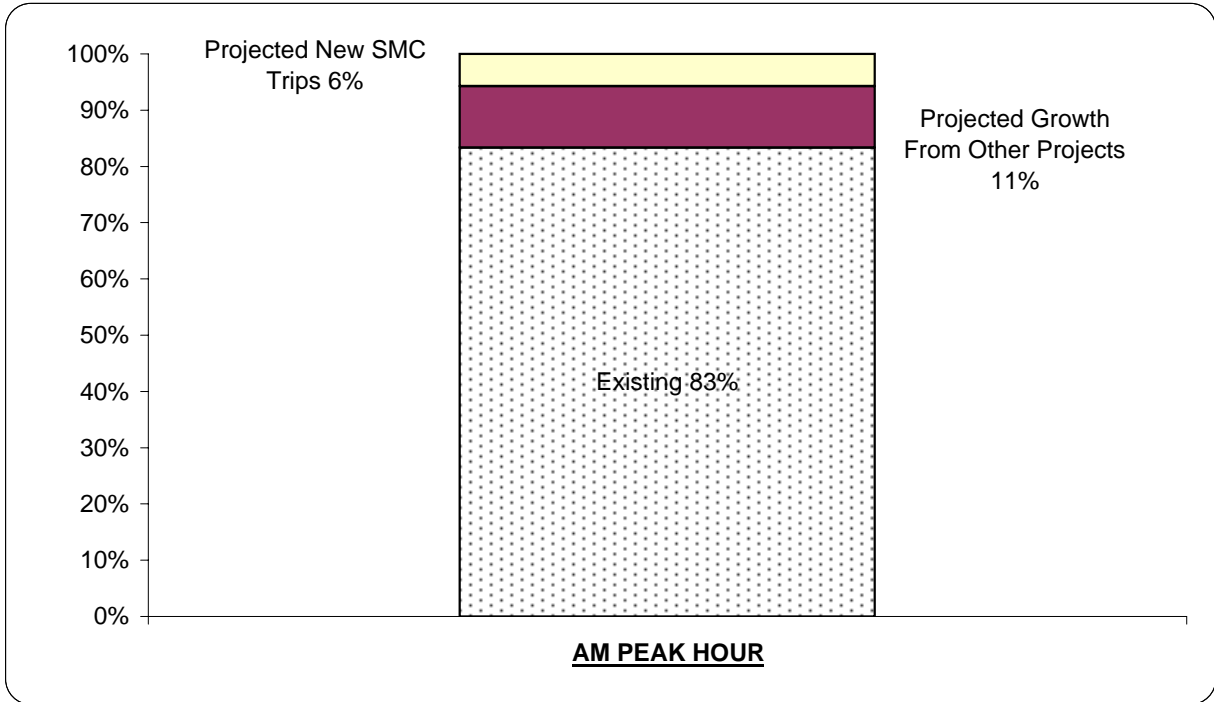

**FIGURE 4  
PROPORTIONS OF TOTAL PROJECTED TRAFFIC VOLUMES  
WITH 800 SPACE PARKING STRUCTURE**

Note: Proportions of total projected peak hour traffic at Intersections 2, 9, and 11.

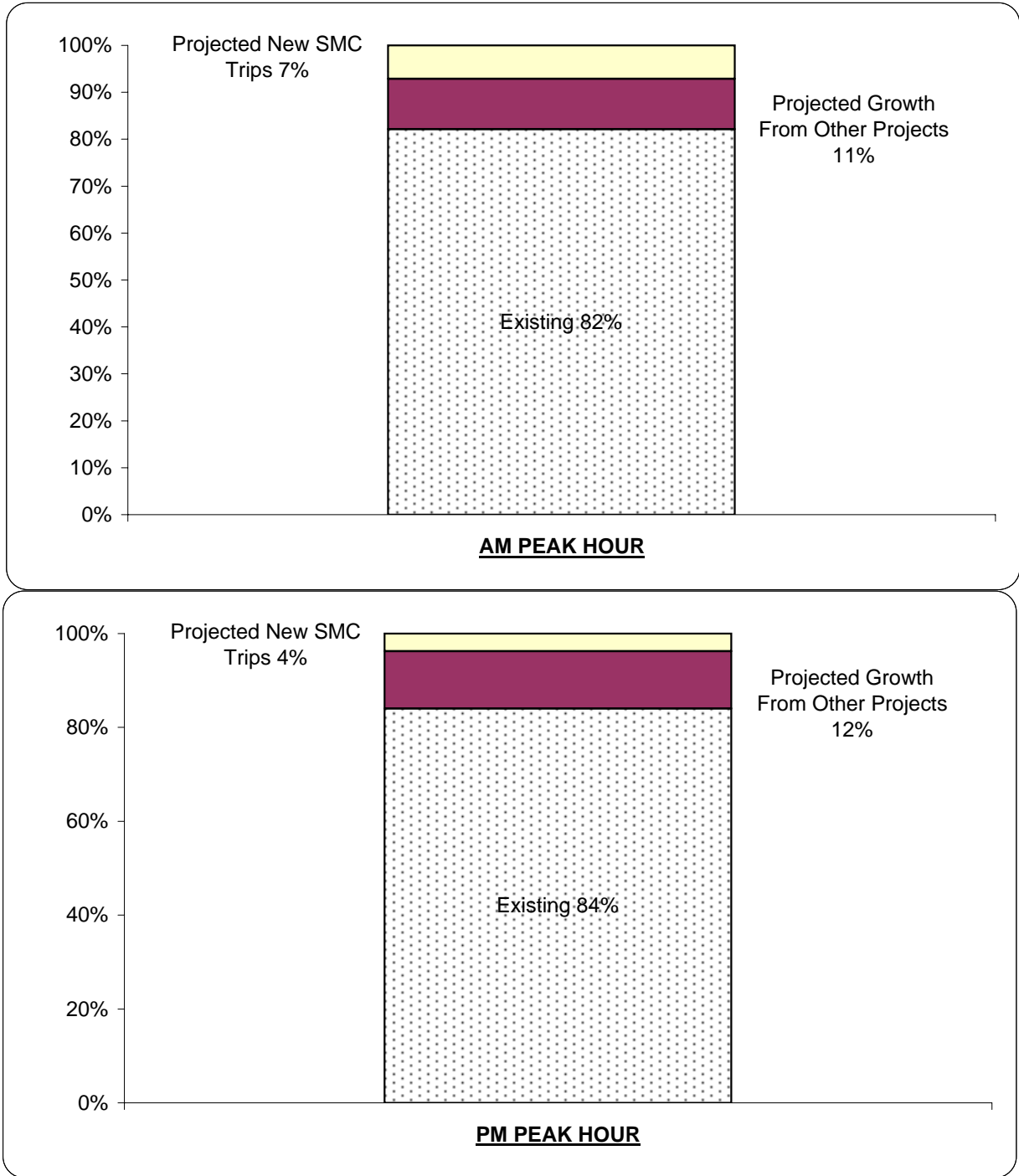

**FIGURE 5  
PROPORTIONS OF TOTAL PROJECTED TRAFFIC VOLUMES  
WITH 1,000 SPACE PARKING STRUCTURE**

Note: Proportions of total projected peak hour traffic at Intersections 2, 9, and 11.

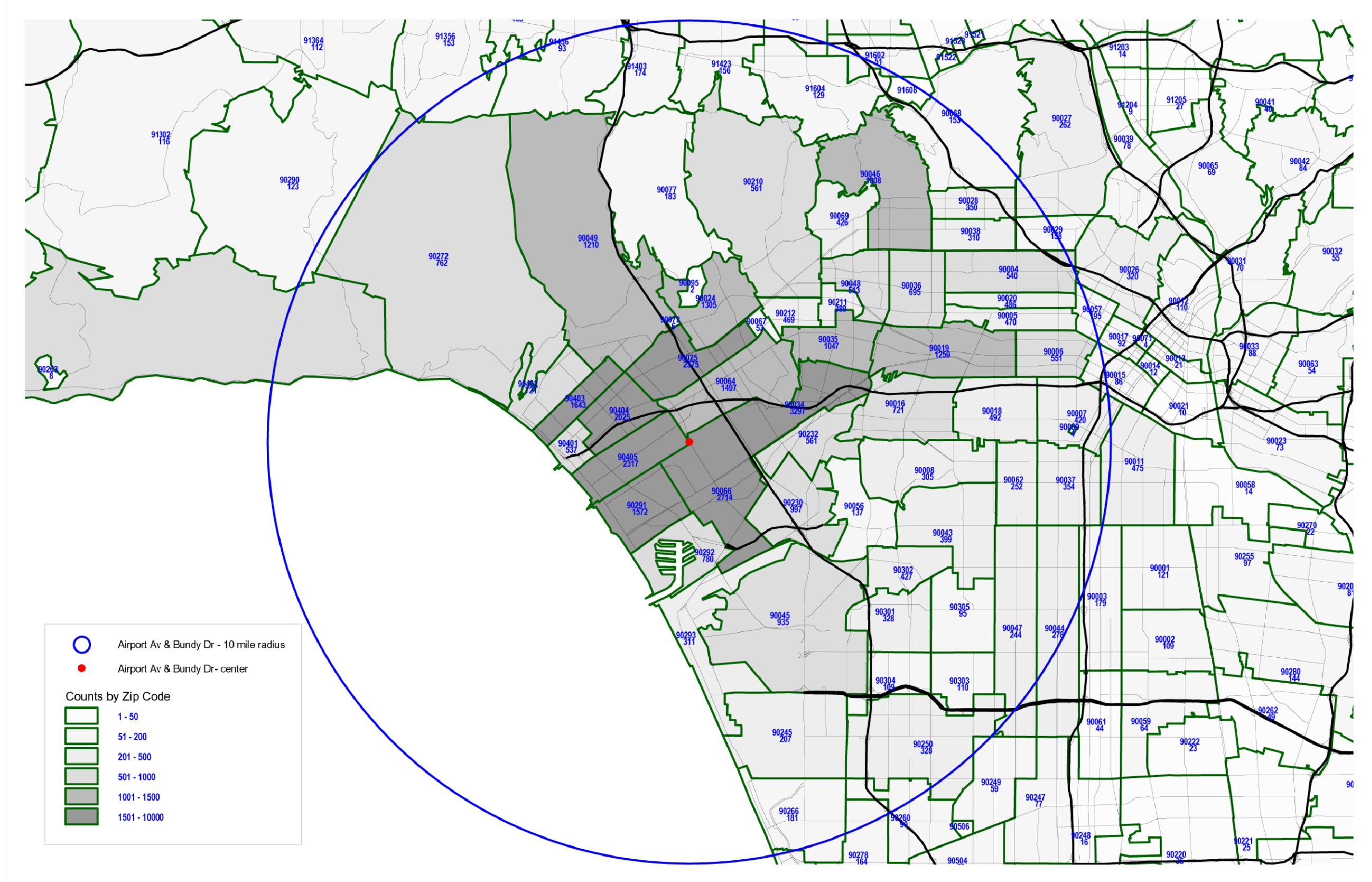
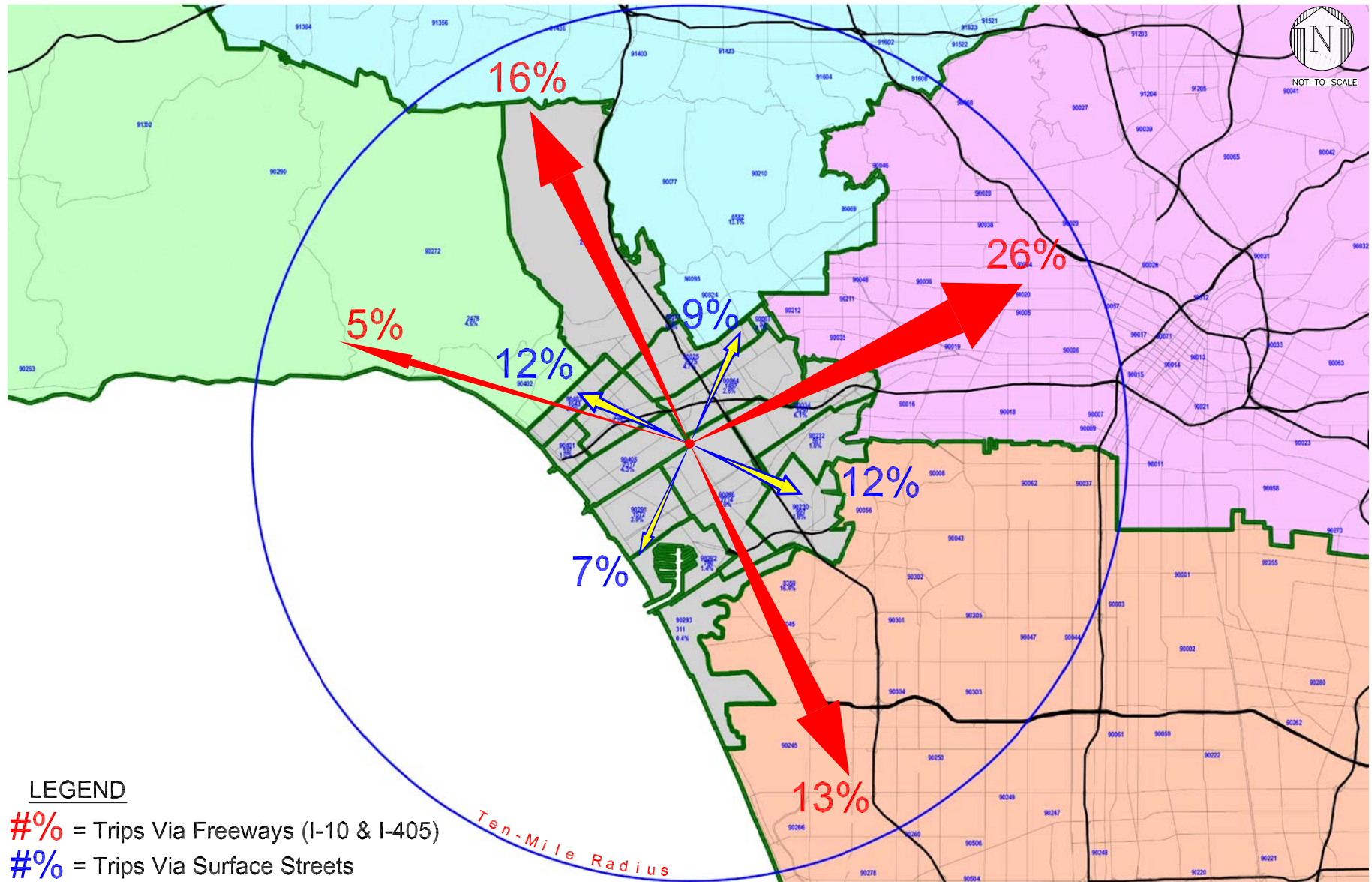

FIGURE 6  
DISTRIBUTION OF ENROLLED STUDENTS (2002 - 2003)



**LEGEND**

- #%** = Trips Via Freeways (I-10 & I-405)
- #%** = Trips Via Surface Streets
- = Sunset Vista Campus

**FIGURE 7  
ESTIMATED TRIP DISTRIBUTION**





NOT TO SCALE

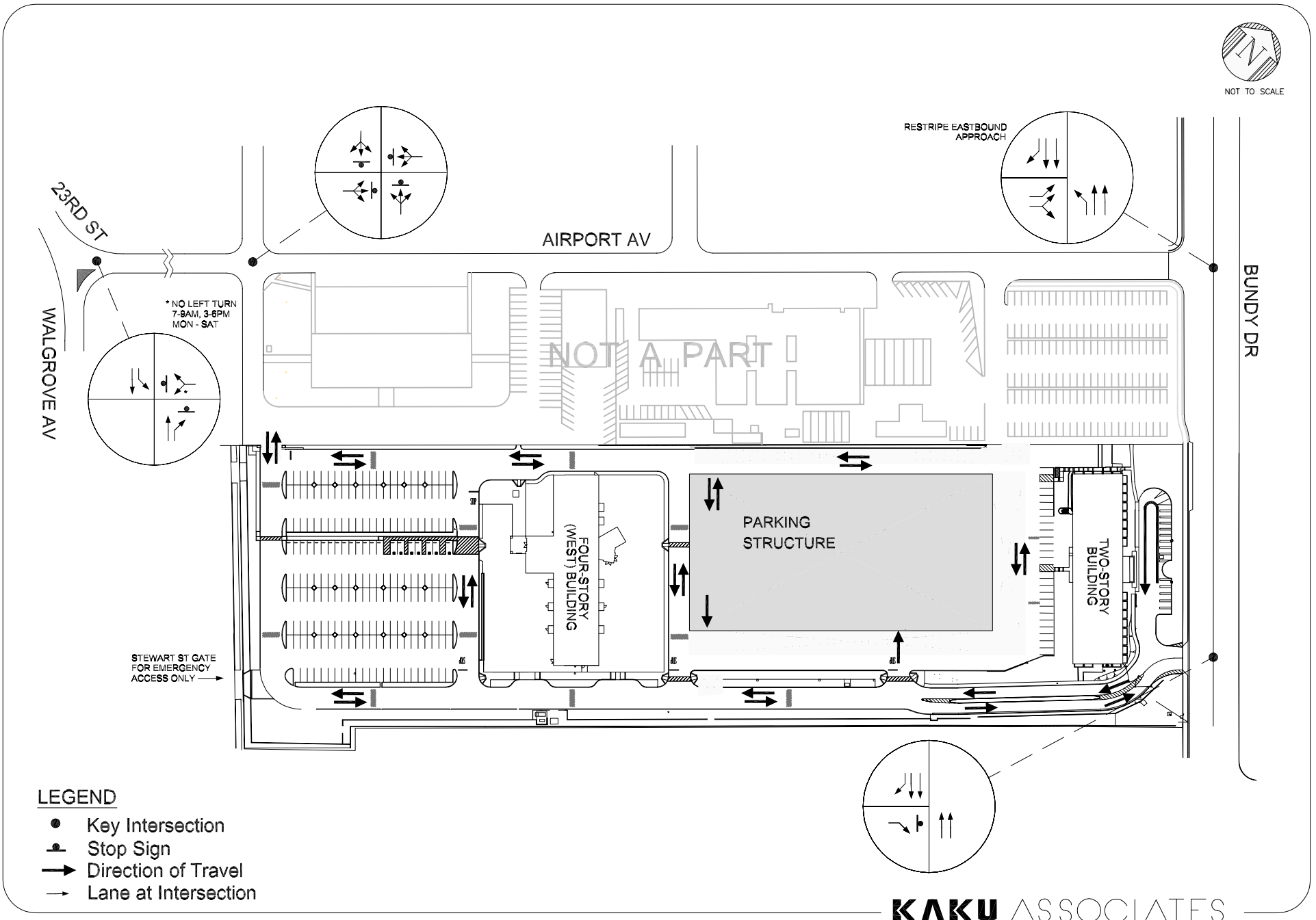

FIGURE 8  
ALTERNATIVE 1



NOT TO SCALE

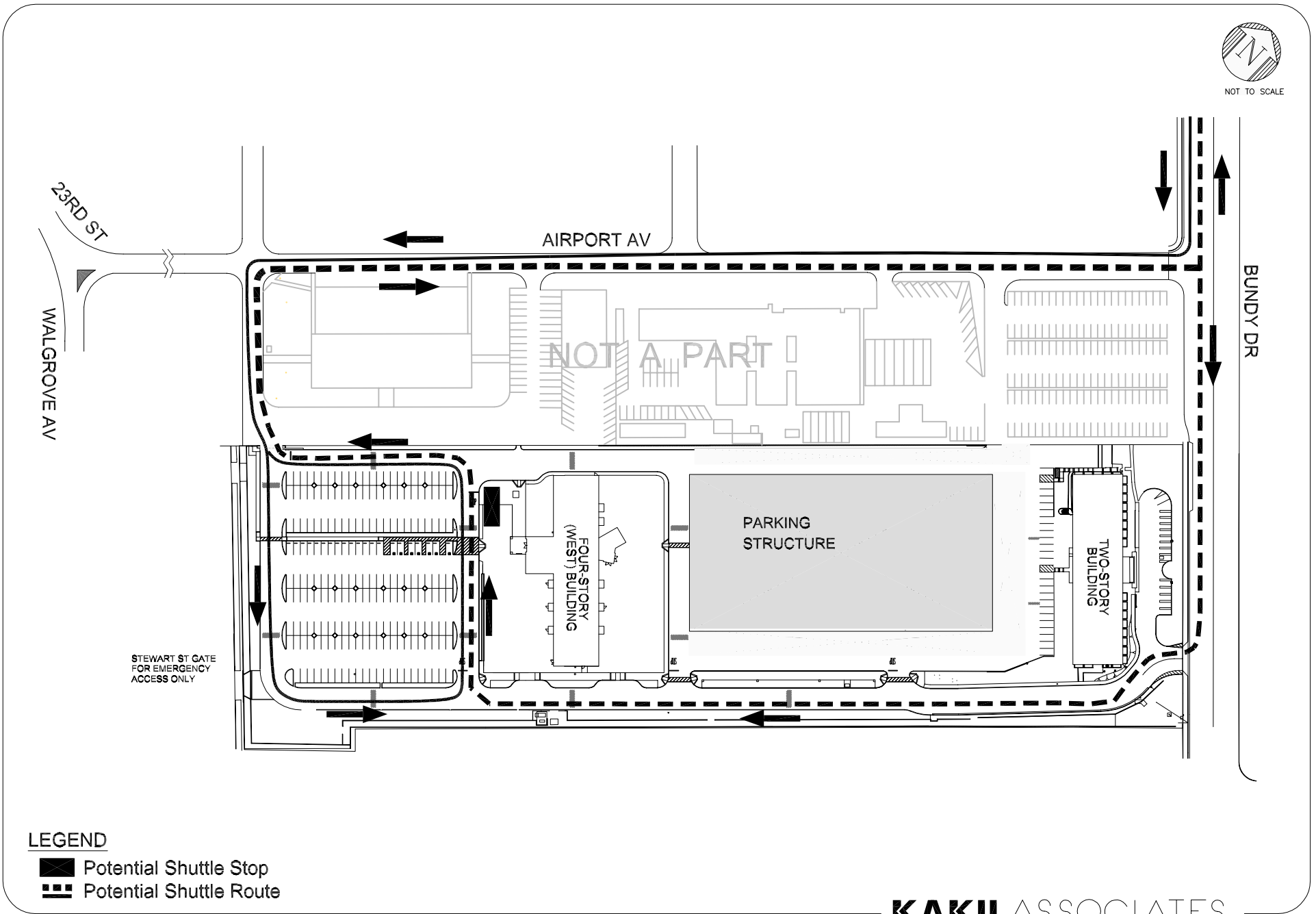
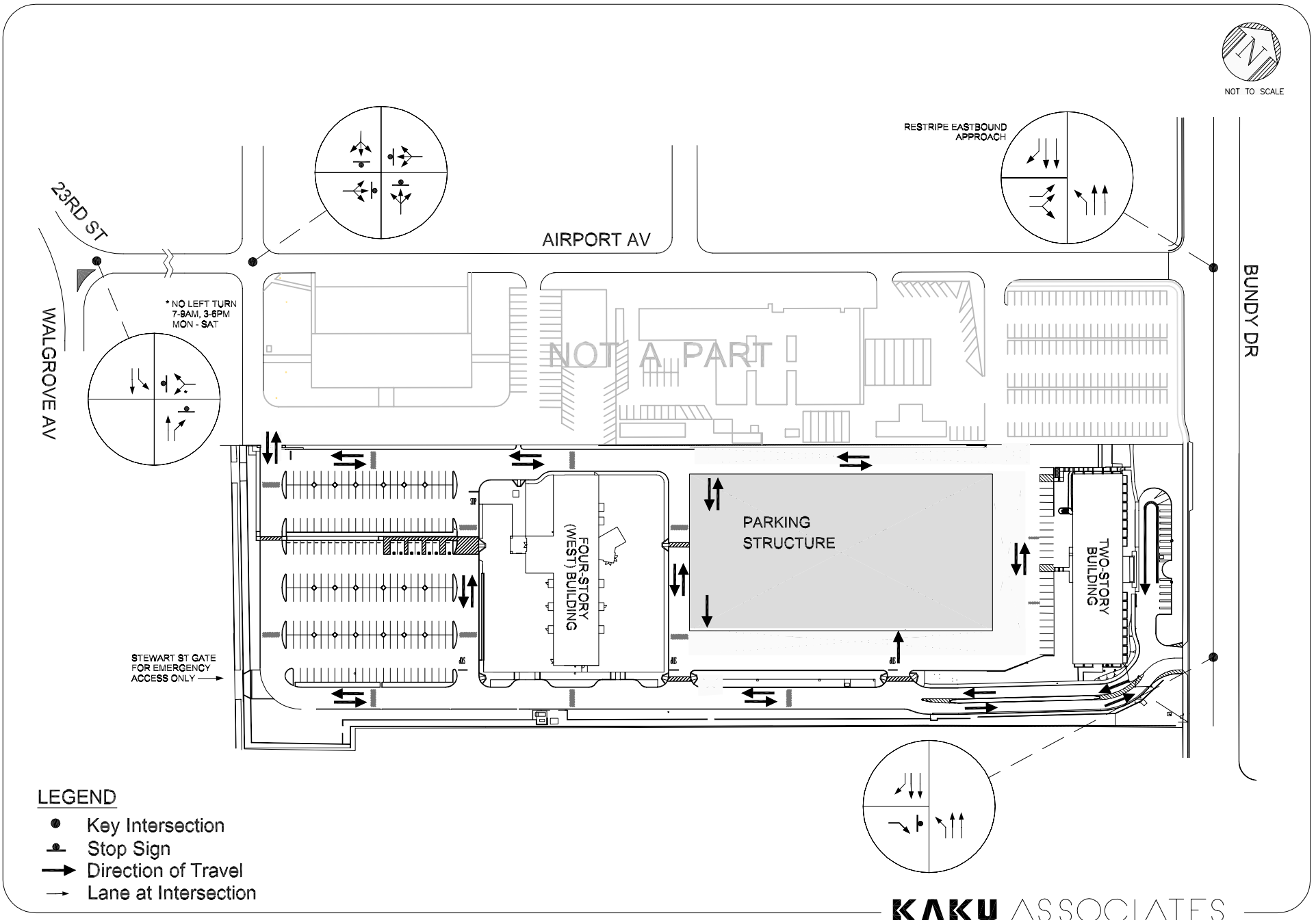

FIGURE 9  
POTENTIAL SHUTTLE BUS ROUTING OPTIONS - ALTERNATIVES 1,2,3 & 5



NOT TO SCALE



**LEGEND**

- Key Intersection
- ⊥ Stop Sign
- ➔ Direction of Travel
- Lane at Intersection

**KAKU ASSOCIATES**

**FIGURE 10  
ALTERNATIVE 2**



NOT TO SCALE

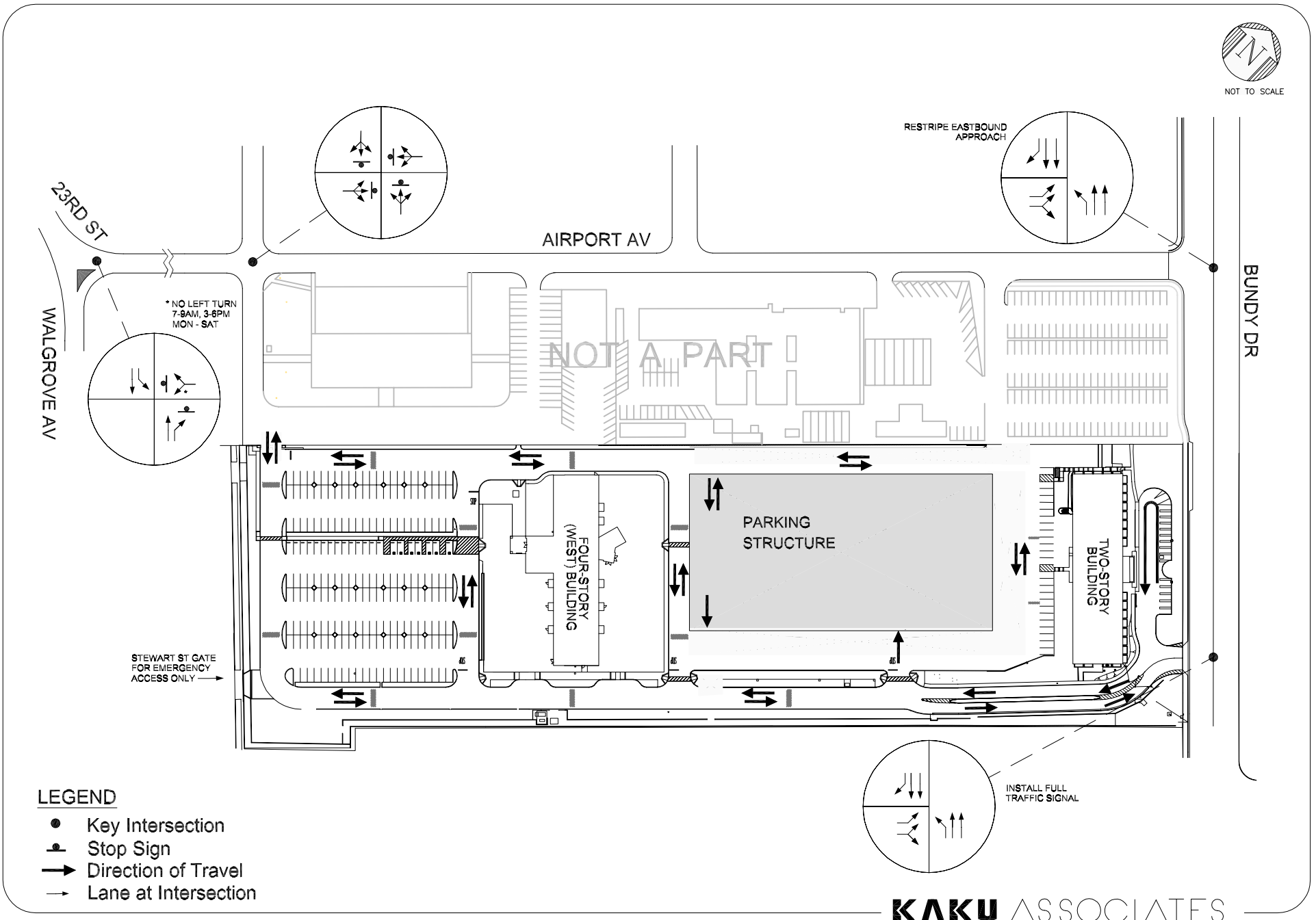
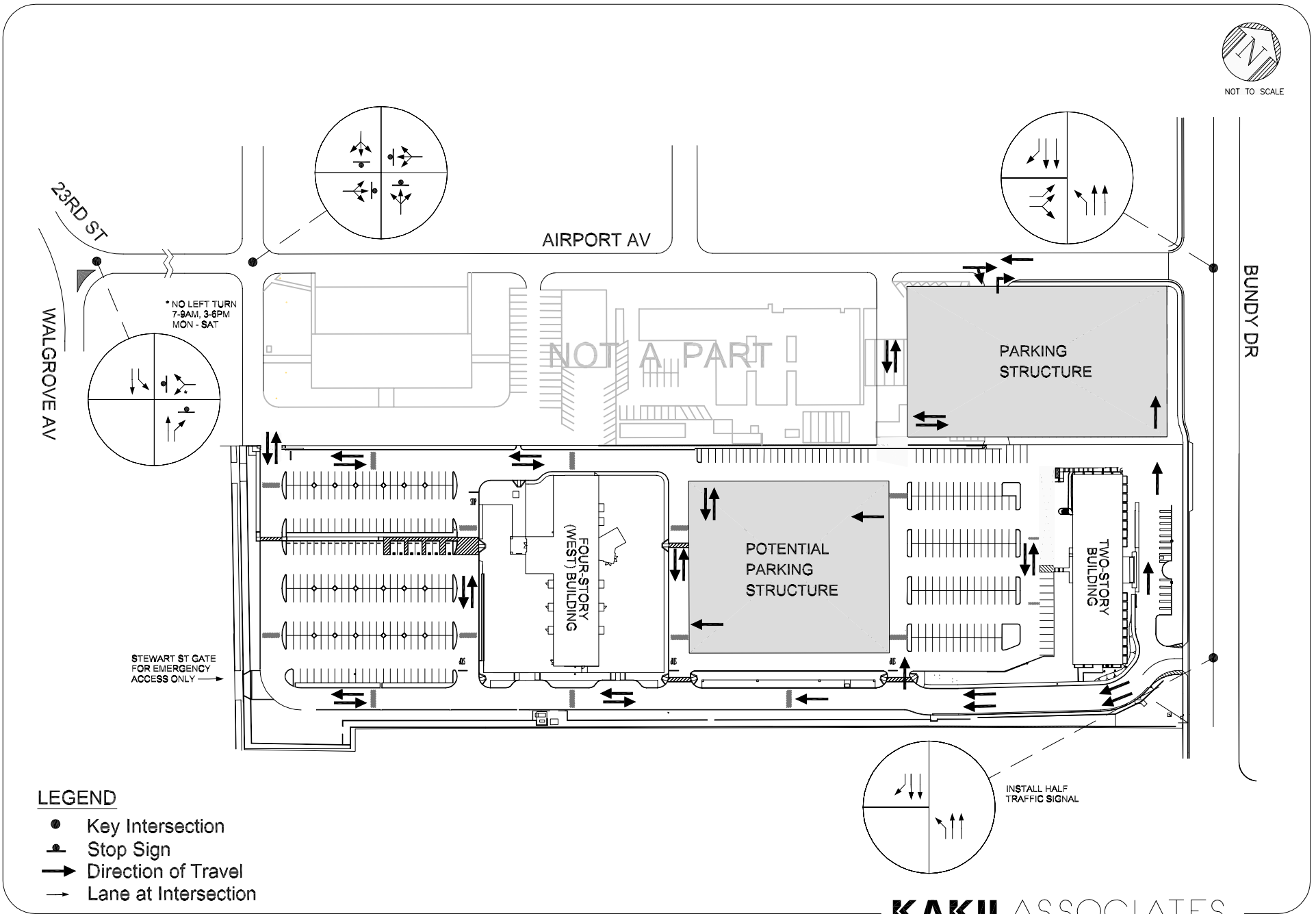

FIGURE 11  
ALTERNATIVE 3



NOT TO SCALE



**LEGEND**

- Key Intersection
- ⊥ Stop Sign
- ➔ Direction of Travel
- Lane at Intersection

**KAKU ASSOCIATES**

**FIGURE 12  
ALTERNATIVE 4**



NOT TO SCALE

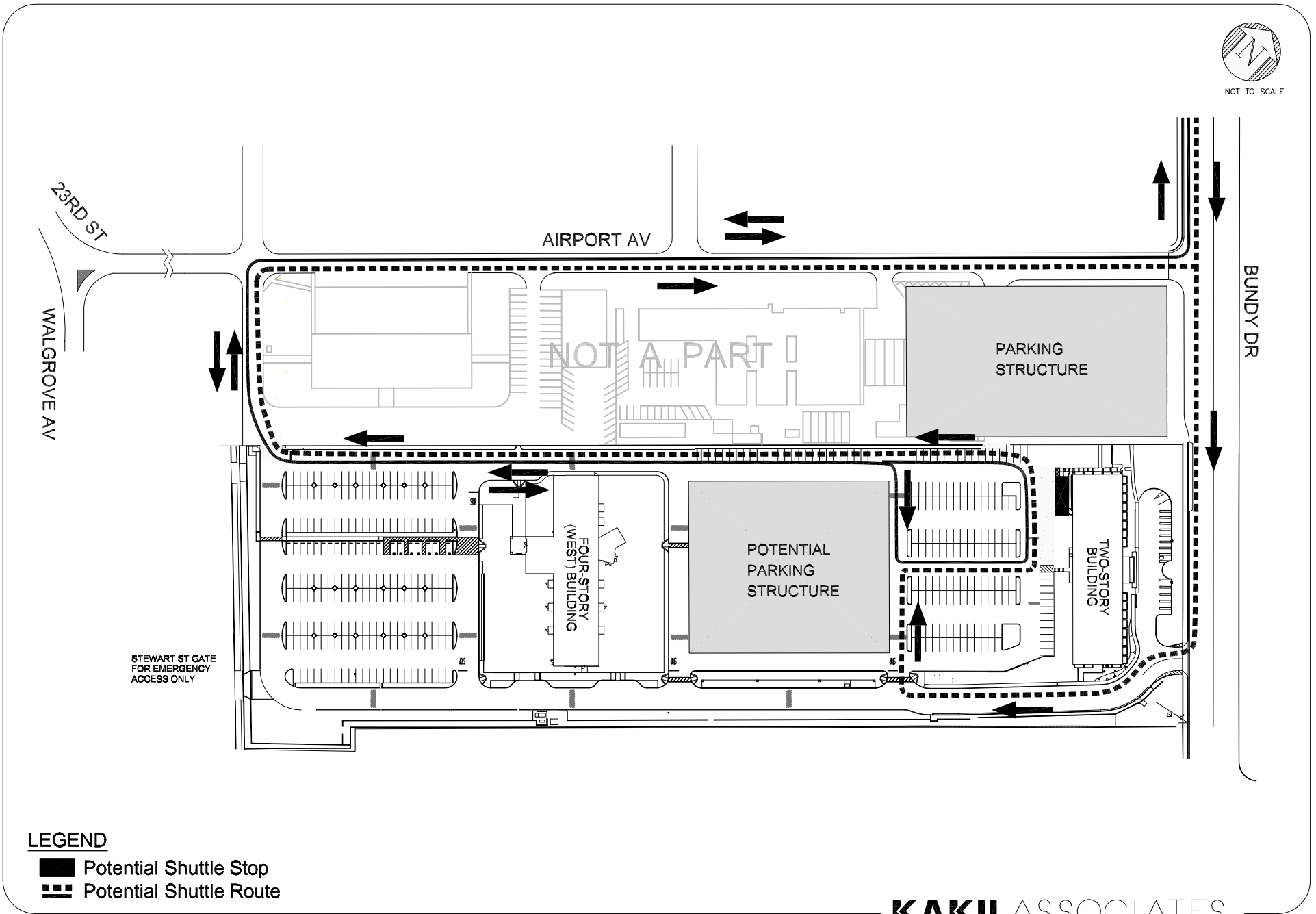
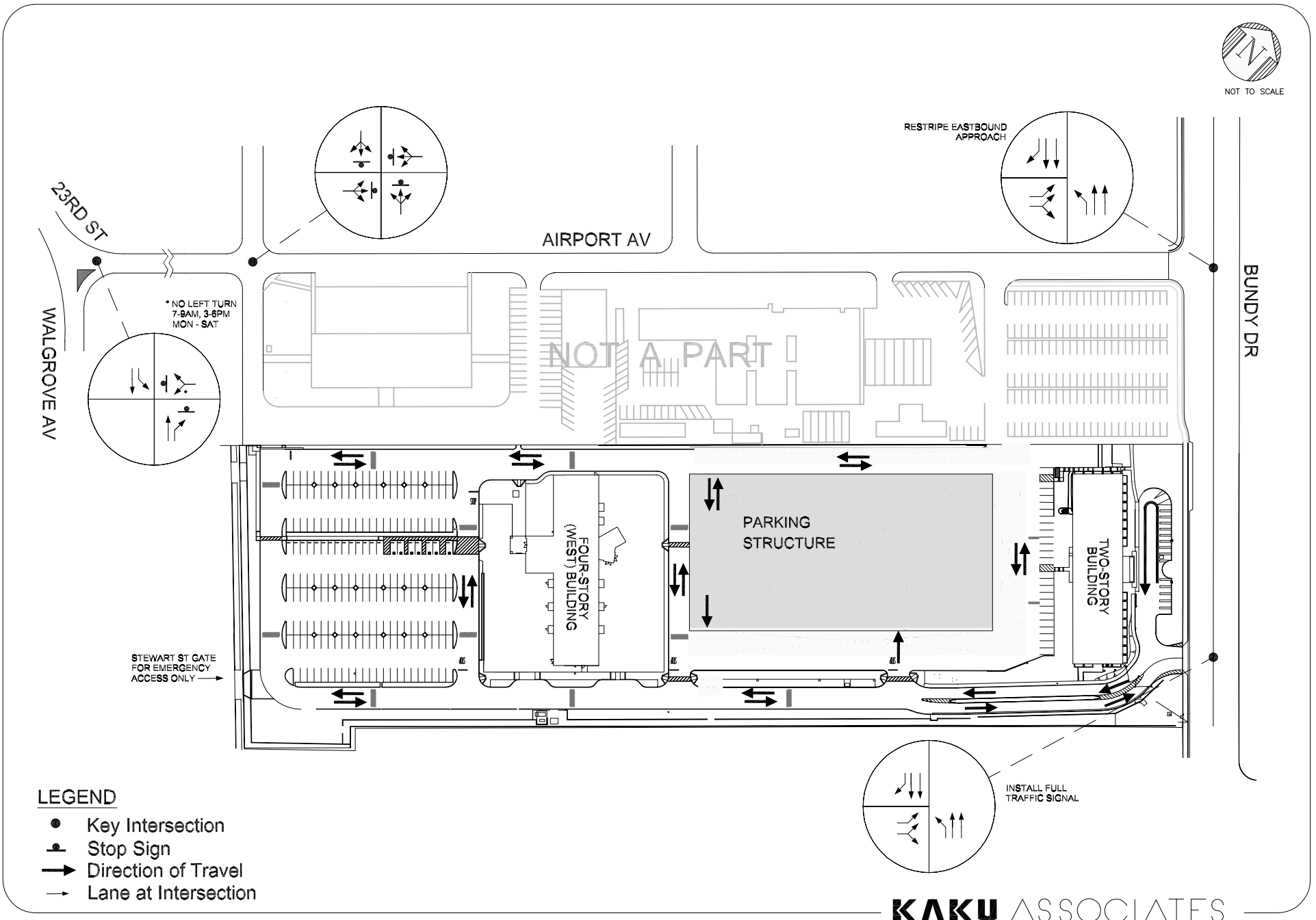

FIGURE 13  
POTENTIAL SHUTTLE BUS ROUTING OPTIONS - ALTERNATIVE 4



NOT TO SCALE



**LEGEND**

- Key Intersection
- ⊥ Stop Sign
- ➔ Direction of Travel
- Lane at Intersection

**KAKU ASSOCIATES**

**FIGURE 14  
ALTERNATIVE 5**