

# AZURE VIRTUAL DESKTOP (AVD) ON CHROMEBOOK

**Note 1:** Please ensure your Chromebook has the latest updates installed before following these instructions.

**Note 2:** The instructions will work only on Chromebooks that support Android Apps. **If your Chromebook does not support Android Apps**, please use the WebApp using Chrome: <https://rdweb.wvd.microsoft.com/webclient>

## INSTALLATION

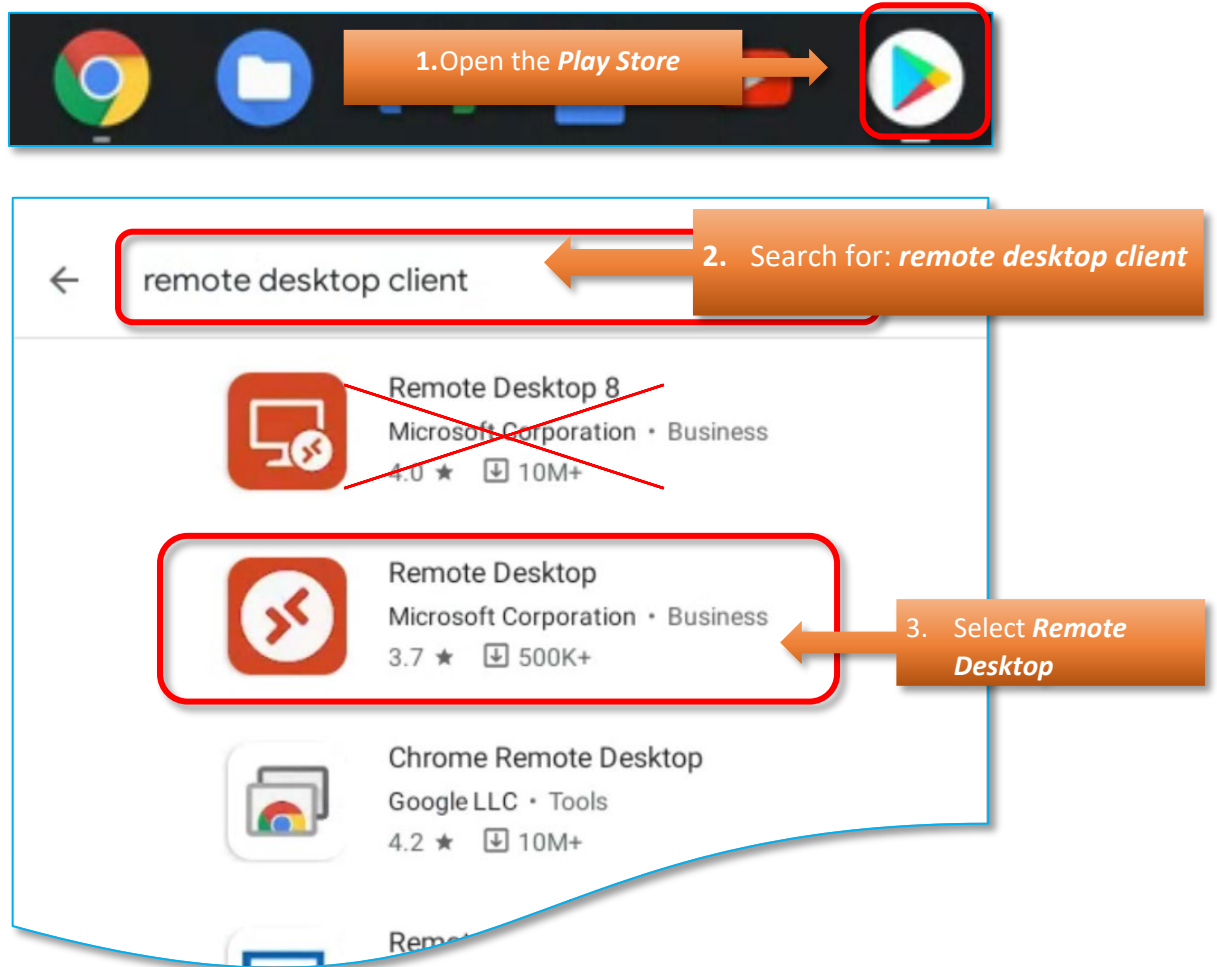

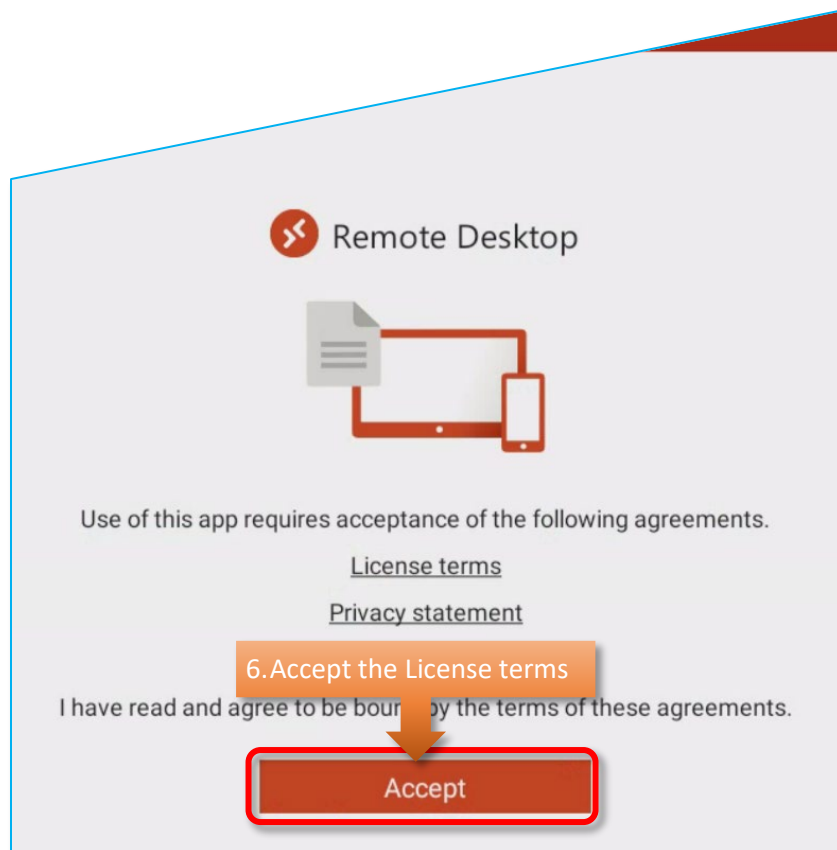
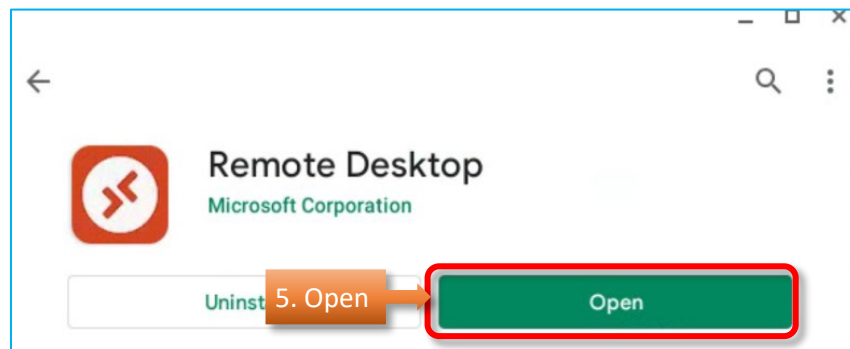
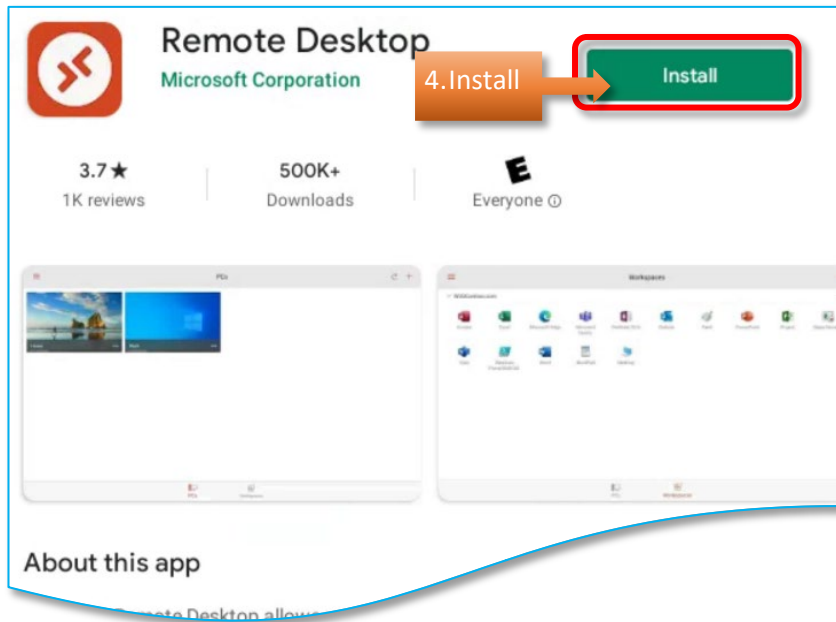

## CONFIGURATION

The screenshot shows the 'Workspaces' tab selected in the Remote Desktop Client. The interface includes a top bar with a '+' icon, a main area with 'Add PC' and 'Add Workspace' buttons, and a bottom dock with 'PCs' and 'Workspaces' icons. A green callout points to the RD Client icon in the dock.

2. Click on the + at the top right of the app.

1. Open Remote Desktop Client, and select the "Workspaces" tab at the bottom of the app

3. Select "Add Workspace"

Pin the RD Client, if you wish

The 'Add Workspace' dialog box is shown with a text input field containing an email address, a 'NEXT' button, and a 'WORKSPACE URL' field. A callout box provides an alternative URL.

4. Enter your SMC email

6. Next

last\_first@student.smc.edu

A workspace is associated with this email address.

WORKSPACE URL

https://rdweb.wvd.microsoft.com/api/arm/feeddiscovery

5. If a Workspace URL is not associated, instead of your email please enter:  
**https://rdweb.wvd.microsoft.com/api/arm/feeddiscovery**

Privacy settings for managed resources have been preset by your organization.

Learn more about privacy settings...

Microsoft

## Sign in

7. Enter your SMC email

last\_first@student.smc.edu

Can't access your account?

Back Next

### SMC SIGN-ON

Username

last\_first@student.smc.edu

Password

.....

Show password

Employee Forgot Password

Login

8. Enter your SMC email and SMC password.

Workspaces

SMC Virtual Lab

SMC VCL Desktop

9. After signing on, you should see all Virtual Desktops assigned to you. Double click to open the Virtual Machine.

### Enter Your User Account

10. Type your SMC email and SMC password one more time

USERNAME

last\_first@student.smc.edu

PASSWORD

.....

Store username and password

CANCEL CONTINUE

**Make sure you trust the remote PC before you connect.**

This connection is from a remote PC. **11. Select any local resources you would like to have available on the VM**

User account: [redacted]  
PC name: [redacted]  
Gateway: afdp-rdgateway-wvd.microsoft.com:443

Let the remote PC access the following resource:

- Local storage
- Clipboard
- Never ask again for connections to this PC

CANCEL **CONNECT**

**12. Verify your selection on Chrome OS**

Allow **Microsoft Remote Desk...** to access photos, media, and files on your device?

1 of 2 DENY **ALLOW**

Allow **Microsoft Remote Desk...** to record audio?

2 of 2 DENY **ALLOW**

**13. Log Off, whenever you are done with your work. Be sure to save to save your work to your local machine or OneDrive before logging off.**

The desktop shows a blue background with icons for Recycle Bin, Firefox, Google Chrome, Log Off (highlighted with a red box and an arrow), Microsoft Edge, and Unity Hub. The taskbar at the bottom includes the Start button, search bar, task view, and system tray with the time 12:15 PM and date 3/17/2021.